



Zone controller
MWR-ZS00*
MWR-ZS10*

Air Conditioner user manual



100%
Recycled Paper

This manual is made with 100% recycled paper.

imagine the possibilities

Thank you for purchasing this Samsung product.

G-116338 REV. 2

SAMSUNG

Contents

Preapartion

Safety Precautions	3
Name of the parts	4

Basic function

Basic operation	8
Controlling individual zone	10
Other functions	12

Schedule

Setting the current time	14
Setting the timer	15

Setting



Using the Smart tuning function	20
Checking the error	21
Resetting the filter cleaning alarm	22
User mode	22

Safety Precautions

Before using the Zone controller, read the instructions in this booklet carefully.

Keep this user manual with the installation manual in a handy and safe place. If the user of this product changes, hand over the manuals to the new user.

Never attempt to install the air conditioning system or move the Zone controller by yourself.

 WARNING	Hazards or unsafe practices that may result in severe personal injury or death .
 CAUTION	Hazards or unsafe practices that may result in minor personal injury or property damage .

SEVERE WARNING SIGNS

- ▶ Do not attempt to install or repair this product by yourself.
- ▶ This product contains no user-serviceable parts. So always consult an authorized service personnel for repairs.
- ▶ When moving, consult an authorized service personnel for disconnection and re-installation of the Zone controller.
- ▶ Ensure that the wall is strong enough to support the weight of the Zone controller.
- ▶ Install the product using the proper electric power.
- ▶ In the event of a malfunction (burning smell, etc.), immediately stop the operation, turn off the electrical breaker, and consult an authorized service personnel.

CAUTION SIGNS

- ▶ Do not install this product in places where it will come into contact with volatile substances such as machine oil, benzene, gasoline or naphtha.
- ▶ Do not install this product in places where it will come into contact with combustible gases such as sulfuric gas, hydrogen gas, methane gas, etc.
- ▶ Do not spill liquid of any kind into the Zone controller.
- ▶ Do not operate this product with wet hands.
- ▶ Avoid using spray products such as insecticides near this product.
- ▶ Do not press the buttons on the Zone connector with a sharp object.
- ▶ To avoid disconnection, do not over-stretch the cables during installation.
- ▶ Do not use this product for other purposes.
- ▶ Do not clean this product with substances such as benzene or acid/alkali solvents.

Name of the parts

Master controller (MWR-ZS00*)

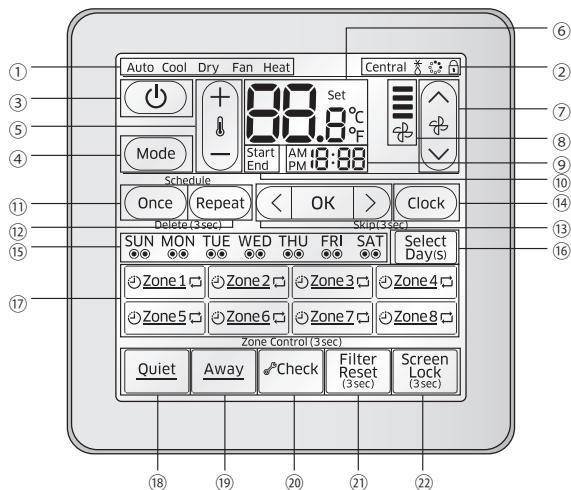





Part	Indication		Name and explanation
Indicator	①	Auto Cool Dry Fan Heat	Operation mode indicator <ul style="list-style-type: none"> Selected operation mode appears
	②	Central	Option (Central, Defrost, Virus doctor, Screen lock) indicator <ul style="list-style-type: none"> Central icon appears when indoor unit is under central control. * icon appears when outdoor unit operates in defrost mode. icon appears when virus doctor function is activated. <div style="border: 1px solid black; padding: 5px; margin-top: 10px;"> <p>NOTE</p> <ul style="list-style-type: none"> When Virus doctor is equipped, it will turn on when the indoor unit turns on and turn off when the indoor unit turns off. You cannot turn on/off the Virus doctor by separately by using the Zone controller. </div> <ul style="list-style-type: none"> icon appears when the screen is locked.
Main Control	③		Power button <ul style="list-style-type: none"> Tap to turn on/off the indoor unit
	④		Mode button <ul style="list-style-type: none"> Tap to select desired operation mode
	⑤		Temperature adjustment button <ul style="list-style-type: none"> Tap + and – to increase or decrease the desired temperature
	⑥		Temperature indicator <ul style="list-style-type: none"> Desired temperature appears (default setting, it can be changed.) Tap and hold to view current room temperature When Demand Response signal occurs; <ul style="list-style-type: none"> Temperature and DRED level (1~3) will be displayed alternately in 1 second interval in Cool/Heat mode (ex: 24.0) Only DRED level (1~3) will be displayed in Fan mode (ex: 1)



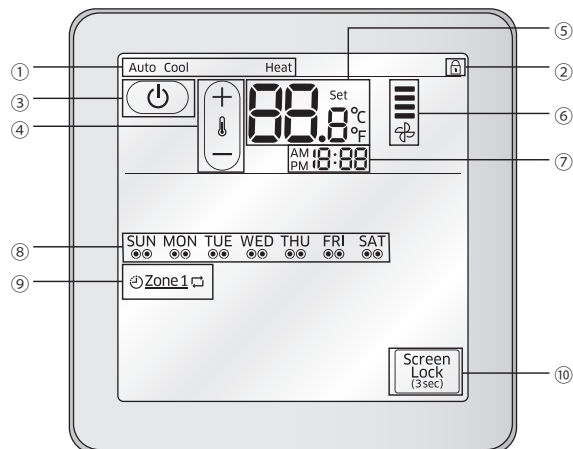





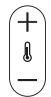

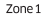
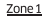

Part	Indication		Name and explanation
Main Control	⑦		Fan speed adjustment button • Tap up and down arrow to select desired fan speed
	⑧		Fan speed indicator • Selected Fan speed (Auto/Low/Medium/High) appears here
	⑨		Time indicator • Current time appears • Used to set the time for a schedule
	⑩		Timer start/end selection indicator • Appears when selecting start/end time for a timer
Schedule & Zone Setting	⑪		Once button • Tap to set non-repetitive timer
	⑫		Repeat button • Tap to set repetitive (weekly) timer
	⑬		Select/OK button • Tap <, > button to select options for timer and clock • Tap OK button to set the selected options
	⑭		Clock button • Tap to set current time
	⑮		Repetitive (Weekly) timer indicator • Shows the status of the repetitive (weekly) timer
	⑯		Select Day(s) button • Tap to select the day(s) to set up repetitive (weekly) timer Selected: / Not selected:
	⑰		Zone selection button • Tap to open/close the damper for zone 1 through 8 • Tap and hold to control individual zone Damp closed: / Damp opened: • Non-repetitive timer icon Appears when non-repetitive timer is scheduled in such zone Not scheduled: / Scheduled: • Repetitive (Weekly) timer icon Appears when repetitive (weekly) timer is scheduled in such zone Not scheduled: / Scheduled:
Options	⑱		Quiet button • Tap to activate/deactivate Quiet mode
	⑲		Away button • Tap to activate/deactivate Away mode • Only the text "away" appears in the model with away mode
	⑳		Check button • Displayed during the initial set up stage • Normally inactive but blinks when checking is needed
	㉑		Filter Reset (3sec) button • Normally inactive but blinks when time is reached for filter cleaning
	㉒		Screen Lock (3sec) button • Tap and hold for 3 seconds to lock/unlock screen

Name of the parts

Slave (Individual zone) controller (MWR-ZS10*)



Part	Indication		Name and explanation
Indicator	①	Auto Cool Heat	<p>Operation mode indicator</p> <ul style="list-style-type: none"> Slave controller does not display the operation mode of the indoor unit. Only Auto, Cool and Heat will be displayed accordingly. 'Auto' will be displayed when the desired temperature is set to a zone to controller the damper automatically. 'Auto' and 'Heat' or 'Cool' can be displayed at the same time. 'Cool' will be displayed when the indoor unit is operating in Cool, Dry or Fan mode. 'Heat' will be displayed when the indoor unit is operating in Heat mode. <p>NOTE</p> <ul style="list-style-type: none"> When the desired temperature is set to a zone, 'Auto' will appear however, it will disappear when you open/close the damper manually by using the Power button or by the master controller.
	②		<p>Screen lock indicator</p> <ul style="list-style-type: none"> Appears when the screen is locked. Command cannot be executed and  icon will blink for 3 seconds when; <ul style="list-style-type: none"> If you have selected the temperature that is beyond the range of upper or lower temperature limit.
Main Control	③		<p>Power button</p> <ul style="list-style-type: none"> Tap to turn on/off the damper
	④		<p>Temperature adjustment button</p> <ul style="list-style-type: none"> Tap + and - to increase or decrease the desired temperature When the room temperature has not reached the desired temperature, damper will remain open

Part	Indication		Name and explanation
Main Control	⑤		Temperature indicator <ul style="list-style-type: none"> Desired temperature appears (default setting, it can be changed.) Tap and hold to view current room temperature
	⑥		Fan speed indicator <ul style="list-style-type: none"> Selected Fan speed (Auto /Low/Medium/High) from the master
	⑦		Time indicator <ul style="list-style-type: none"> Current time appears
	⑧		Repetitive (Weekly) timer indicator <ul style="list-style-type: none"> Shows the status of the repetitive (weekly) timer
	⑨		Zone /Schedule indicator <ul style="list-style-type: none"> Displays current zone number Displays status of damper Damp closed:  / Damp opened:  Non-repetitive timer icon  Appears when non-repetitive timer is scheduled in such zone Not scheduled:  / Scheduled:  Repetitive (Weekly) timer icon  Appears when repetitive (weekly) timer is scheduled in such zone Not scheduled:  / Scheduled: 
	⑩		Screen Lock (3sec) button <ul style="list-style-type: none"> Tap and hold for 3 seconds to lock/unlock screen

Basic operation

Turning on/off the power

Tap the **Power**  button to turn on/off the power.

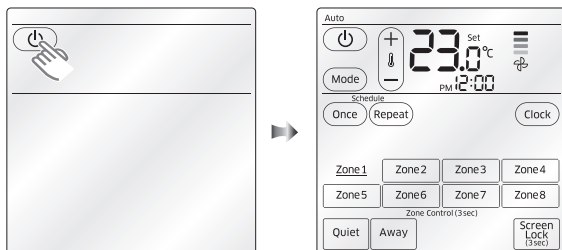

Selecting the operation mode

Press the **Mode** button to set the operation mode.

► Operation mode will be repeated in following order: Auto → Cool → Dry → Fan → Heat

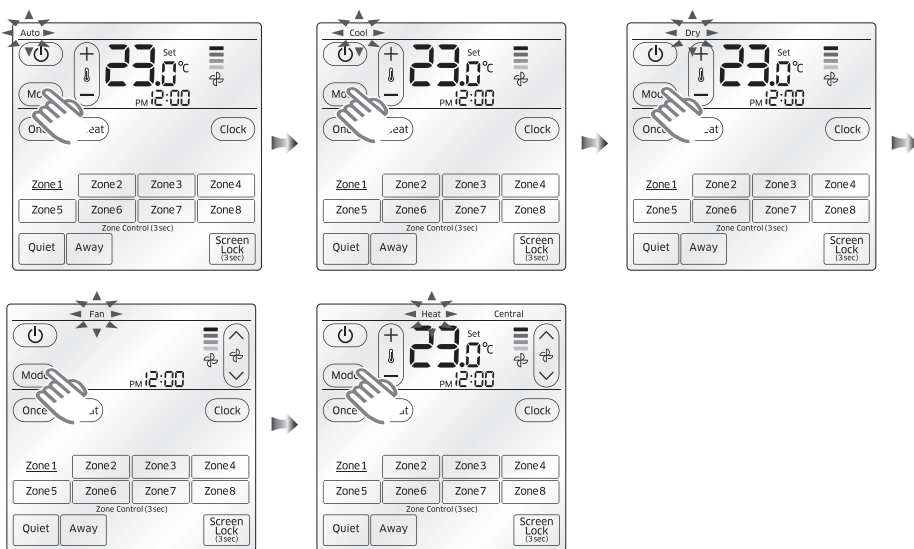

Adjusting the desired temperature

Tap the **Temp** +, - button to adjust the desired temperature.

- ▶ You can increase/decrease the temperature in 0.1/0.5/1.0 °C unit within following temperature range for each mode:

Mode	Temperature range
Auto	18 °C ~ 30 °C
Cool	18 °C ~ 30 °C
Dry	18 °C ~ 30 °C
Fan	Temperature adjustment is not possible
Heat	16 °C ~ 30 °C



- If upper/lower temperature limit was set from user mode, temperature range can be different from information indicated above.
- If you try to set the temperature beyond upper/lower temperature limit, icon will blink for 3 seconds.

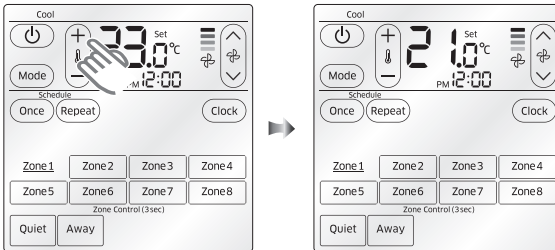

Checking the current room temperature

Tap the temperature indicator to check current room temperature.

- ▶ Default setting for controller was set to display desired temperature.

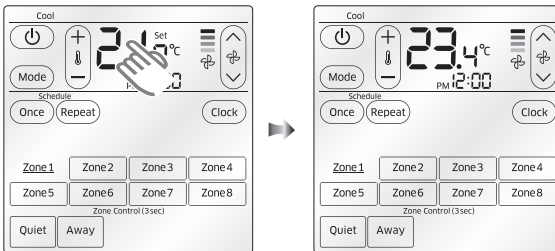

- This function is not available in Fan mode.

Basic operation

Selecting the Fan speed

Tap the **Fan** \wedge , \vee button to set the desired fan speed.

- ▶ You can select one of the following Fan speed :
Auto (Auto) \rightarrow Low (Low) \rightarrow Medium (Med) \rightarrow High (High)
- ▶ Actual fan speed may be different for each operation mode.

Mode	Supported fan speed
Auto	Fan speed is set to auto and cannot be adjusted.
Cool	Auto, Low, Medium, High
Dry	Fan speed is set to auto and cannot be adjusted.
Fan	Auto, Low, Medium, High
Heat	Auto, Low, Medium, High

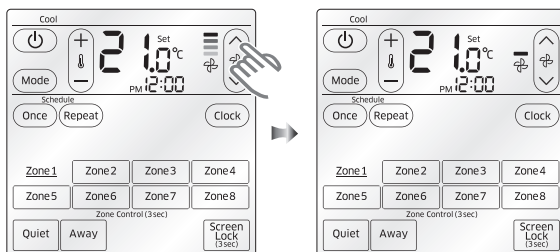

Controlling individual zone

Open/Close the damper for each zone

Tap the button for desired zone(s) to open/close the damper.

- ▶ You can select from Zone 1 ~ Zone 8.
- ▶ Status (Open/close) of the damper for each zone will be displayed as follows.
Damper open: Zone 1 / Damper close: Zone 1

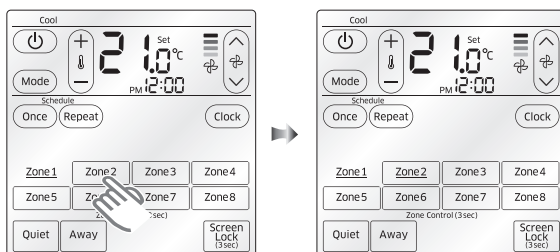

Setting the temperature to open/close the damper automatically

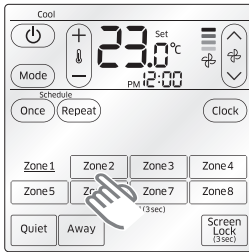

1. Tap and hold the desired Zone (1~8) button for 3 seconds.
 - ▶ When the desired zone is selected, border line for other zones will disappear and only selected zone will have border line.
 - ▶ If the selected zone already has previous temperature setting, it will be displayed in temperature indicator.
 - ▶ If the selected zone doesn't have previous temperature setting, it will display the same temperature set from the master controller.

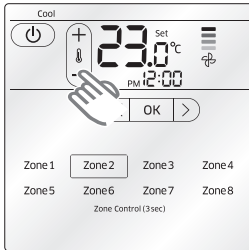

2. Tap the **Temp +, -** button to set the desired temperature for the selected zone.
 - ▶ When the room temperature of the zone reaches the desired temperature, damper will be closed automatically and otherwise, damper will be open.

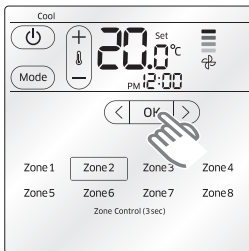

3. Tap the **OK** button to end the setting.
 - ▶ When the temperature setting for the selected zone is complete, temperature indicator will display the temperature set from the master controller.

Other functions

Using the Quiet function

Quiet operation reduces noise of the operation.

Tap the **Quiet** button while the air conditioner is on.

- ▶ Quiet function will be on and the button will be underlined.
- ▶ Tap the **Quiet** button again to cancel the Quiet function.

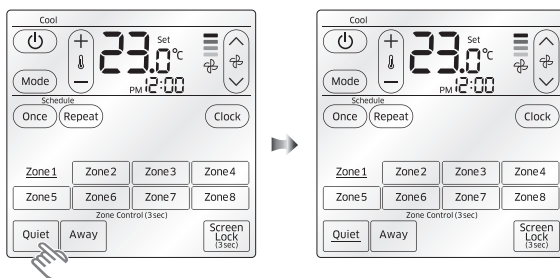

NOTE

- If you select Quiet function in Fan mode or from the unit that doesn't support the function,  will blink for 3 seconds.

Using the Away function

Away operation operates indoor units for set time and turns off automatically.

Tap the **Away** button while the air conditioner is on.

- ▶ Away function will be on and the button will be underlined.
- ▶ Tap the **Away** button again to cancel the Quiet function.

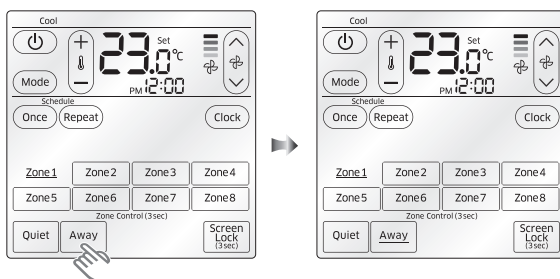

Locking/Unlocking the screen

Tap the **Screen Lock (3sec)** button for 3 seconds to lock/unlock the screen.

- ▶ You may lock/unlock the screen anytime (whether unit is on or off).
- ▶ When the screen is locked, (🔒) icon will appear.

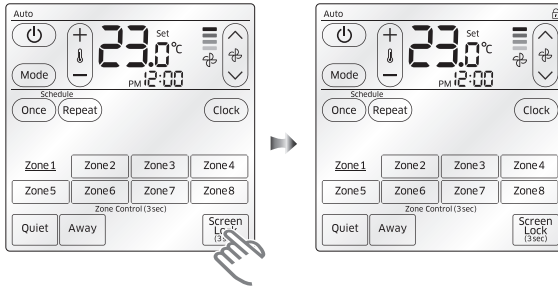

Setting the current time



1. Tap the **Clock** button to set the current time.
▶ **<, OK, >** button will appear and AM will start to blink.

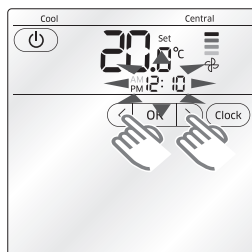

2. Set AM/PM, hour, minute in order.
▶ Tap **<, >** to select the value and tap the **OK** button to set next item.

NOTE

- When you tap the **<, >** button shortly, hour and minute value will increase or decrease by 1. However, if you tap and hold the **<, >** button, it will increase or decrease by 5 and then 10.

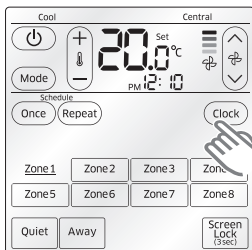

3. Tap the **Clock** button again to complete the time setting.

Setting the timer

Setting the non-repetitive timer

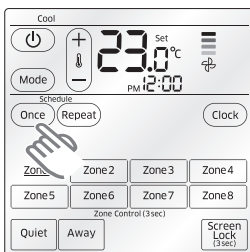

1. Tap the **Once** button.
 - ▶ When you tap the **Once** button, temperature indicator will start to blink.

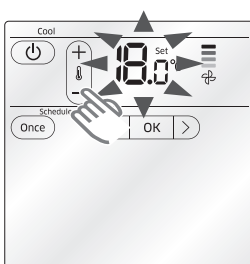

2. Tap the **Temp +/-** button to adjust the desired temperature.
 - ▶ Temperature range for desired temperature is different for each operation mode.
 - ▶ Tap **OK** button and move on to the next step.

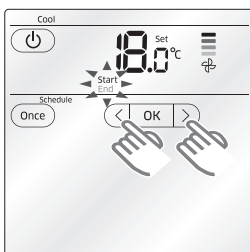

3. Tap the **<, >** button to select Start or End.
 - ▶ Select 'Start' to set the time for the air conditioner to turn on automatically. (After setting the 'Start' time, you can choose to set or skip 'End' time setting.)
 - ▶ Select 'End' to set the time for the air conditioner to turn off automatically. (Air conditioner should be on already to set 'End' time only.)
 - ▶ Tap **OK** button and move on to the next step.

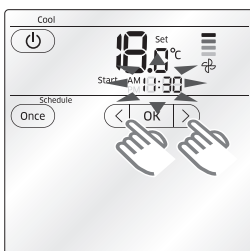

4. Set the 'Start' time for the timer.
 - ▶ Tap **<, >** to select the value and tap the **OK** button to set next item.
 - ▶ Set AM/PM, hour, minute in order.
 - ▶ After setting the minute, tap the **OK** button to move on to 'End' time setting.



NOTE

- Skip this step and move on to the next step if you have selected 'End' from step 3.
- If the current time has already passed the set time, timer will be executed on the next day.

Setting the timer

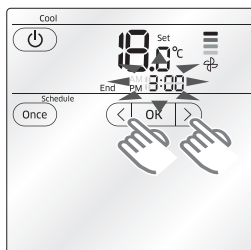

5. Set the 'End' time for the timer.

- ▶ Tap <, > to select the value and tap the **OK** button to set next item.
- ▶ Set AM/PM, hour, minute in order.
- ▶ After setting the minute, tap the **OK** button to move on to the next step.



If you want to turn off the air conditioner manually, tap and hold the > button for 3 seconds and press the **OK** button when the hour and minute display as --:--.

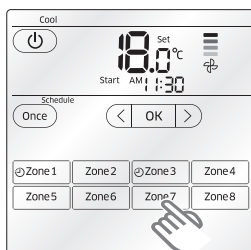

6. Select the zone you wish to apply the timer.

- ▶ You can select as many zones as you want by tapping each Zone button.
- ▶ When timer is applied properly, ☺ icon will appear on the left side of the zone button.
- ▶ After selecting the zone, tap the **OK** button to complete the timer setting.



Previously applied timer setting (that hasn't been executed) will be canceled upon adding a new (non-repetitive) timer.
 You must select at least 1 zone when you set the timer.
 (If you tap the **OK** button without selecting a zone, all the zone indicator will blink twice and wait for the user to select a zone.)
 Select the common zone (Default: Zone 1) if you just want to turn on the indoor unit.

Cancelling the non-repetitive timer

Tap and hold the **Once** button for 3 seconds to delete existing timers.

- ▶ 'Delete (3sec)' is displayed under the '**Once/Repeat**' button when the timer setting exists.
- ▶ ☺ icon will blink for 3 seconds and it will disappear afterwards.
- ▶ Timer is successfully deleted when ☺ icon disappears.



Setting the repetitive (weekly) timer

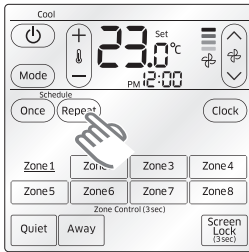

1. Tap the **Repeat** button.
 - ▶ When you tap the **Repeat** button, temperature indicator will start to blink.

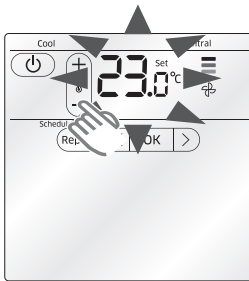

2. Tap the **Temp +, -** button to adjust the desired temperature.
 - ▶ Temperature range for desired temperature is different for each operation mode.
 - ▶ Tap **OK** button and move on to the next step.

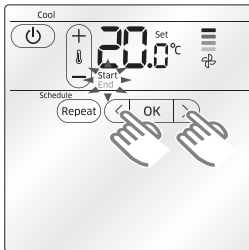

3. Tap the **<, >** button to select Start or End.
 - ▶ Select 'Start' to set the time for the air conditioner to turn on automatically. (After setting the 'Start' time, you can choose to set or skip 'End' time setting.)
 - ▶ Select 'End' to set the time for the air conditioner to turn off automatically. (Air conditioner should be on already to set 'End' time only.)
 - ▶ Tap **OK** button and move on to the next step.

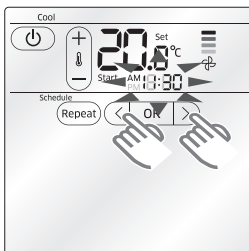

4. Set the 'Start' time for the timer.
 - ▶ Tap **<, >** to select the value and tap the **OK** button to set next item.
 - ▶ Set AM/PM, hour, minute in order.
 - ▶ After setting the minute, tap the **OK** button to move on to 'End' time setting.



NOTE

- Skip this step and move on to the next step if you have selected 'End' from step 3.

Setting the timer

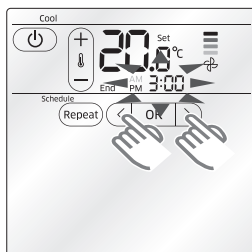

5. Set the 'End' time for the timer.

- ▶ Tap <, > to select the value and tap the **OK** button to set next item.
- ▶ Set AM/PM, hour, minute in order.
- ▶ After setting the minute, tap the **OK** button to move on to the next step.



- If you want to turn off the air conditioner manually, tap and hold the > button for 3 seconds and press the **OK** button when the hour and minute display as --:--.

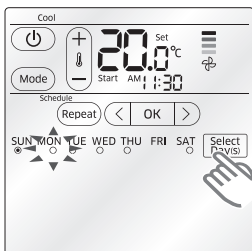

6. Tap <, > button to select the day to apply the timer.

- ▶ Display may differ depending on the previously set weekly timer.

SUN

○: No weekly timer has been set.

MON

○: One weekly timer has been set.

TUE

○: Two weekly time has been set and cannot add another timer.

- ▶ Tap **Select Day(s)** button after selecting the day, ○ will become ● when timer is successfully added.
- ▶ Tap <, > button again to select another day and tap **Select Day(s)** button again to add the timer.
- ▶ When finished applying the timer to desired day(s), tap the **OK** button to complete the setting and move on to the next step.



- You may select as many days as you want but cannot select same day twice.
- If you tap the **OK** button without selecting a day, all the active schedule indicator will blink twice (1 time per second) and wait for the user to select a day.

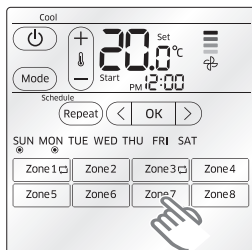

7. Select the zone you wish to apply the timer.

- ▶ You can select as many zones as you want by tapping each **Zone** button.
- ▶ When timer is applied properly, ☐ icon will appear on the right side of the zone button.
- ▶ After selecting the zone, tap the **OK** button to complete the timer setting.







- You must select at least 1 zone when you set the timer.
(If you tap the **OK** button without selecting a zone, all the zone indicator will blink twice and wait for the user to select a zone.)
- Select the common zone (Default: Zone 1) if you just want to turn on the indoor unit.

Cancelling the repetitive (weekly) timer

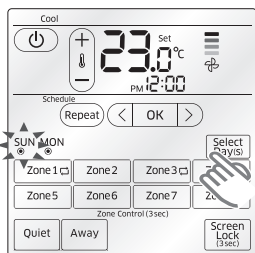

1. Tap and hold the **Repeat** button for 3 seconds to delete existing timers.
 - ▶ 'Delete (3sec)' is displayed under the **Once/Repeat** button when the timer setting exists.

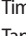
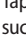

2. Tap the <, > button to select the day you want to delete the timer.
 - ▶ Zones that applied the selected timer will be displayed.
 - ▶  icon will blink for 3 seconds and it will disappear afterwards.
 - ▶ Timer is successfully deleted when  icon disappears.
 - ▶ Tap **Select Day(s)** button after selecting the day,  will become  when timer is successfully removed.
 - ▶ Tap <, > button again to select another day and tap **Select Day(s)** button again to remove the timer.
 - ▶ When finished removing the timer on desired day(s), tap the **OK** button to complete the setting.

Using the Smart tuning function

Smart tuning function adjusts the fan speed.

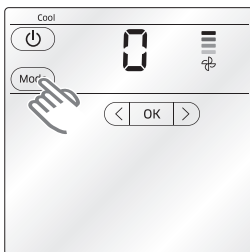

1. Tap and hold the **Mode** button for more than 5 seconds.
 - ▶ <, **OK**, > button will appear and number on the temperature indicator will starts to blink.

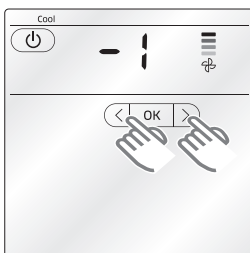

2. Tap <, > button to set the level for air volume.
 - ▶ Default value is set to 0.
 - ▶ You can select from 5 different levels. (-2, -1, 0, 1, 2)
 - ▶ Select larger number if you feel that air volume is weak and small number when too strong.

Checking the error

When there's any error, **Check** button will start to blink and you can check the error code.
Tap and hold the **Check** button for 3 seconds.

- ▶ Error code will be displayed.
- ▶ When all the error is cleared, the **Check** button will disappear.

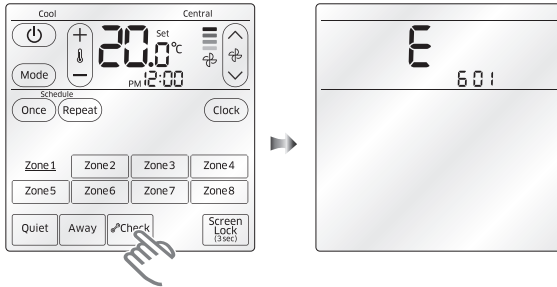

Zone controller error codes

Display	Description
601	Communication error between Zone controller and indoor unit after successful communication.
602	No communication between Master (Main) and Slave (Sub) Zone controllers.
604	No communication between Zone controller and indoor unit.
607	Two or more Zone controllers is set as Master (Main).
620	Zone controller(s) has different temperature unit setting with indoor unit.

Resetting the filter cleaning alarm

After the air conditioner is operated for certain period of time, the **Filter Reset (3sec)** button will blink to alert the user that it's time to clean the filter.

Tap and hold the **Filter Reset (3sec)** button for 3 seconds.

- Filter cleaning alarm will be reset and the **Filter Reset (3sec)** button will disappear.

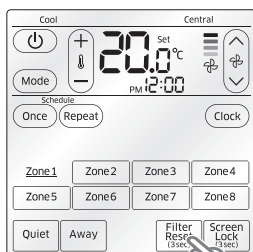

User mode

Setting menu and descriptions of user mode

You can check and/or change below settings from the user mode.

Tap and hold the **Mode** and **Once** button for 3 seconds to enter the user mode.

Main Menu	Sub Menu	Function		SEG No.	Default	Description	Unit
2		Temperature limit	Lower temperature	12	16	16~30°C 61~86°F	1°C/1°F
			Upper temperature	34	30	18~30°C 65~86°F	1°C/1°F
3		All Lock		1	0	0 - Disable, 1 - Enable	-
		Partial button lock	Power button lock	2	0	0 - Disable, 1 - Enable	-
			Mode button lock	3	0	0 - Disable, 1 - Enable	-
			Temperature button lock	4	0	0 - Disable, 1 - Enable	-
			Fan speed button lock	5	0	0 - Disable, 1 - Enable	-
			Schedule button (Once/Repeat) lock	6	0	0 - Disable, 1 - Enable	-
4	1	Current date setting (Year/Month/day)		12/34/56	10/01/01	00~99/1~12/1~31	Year, Month, Day
	2	Current time setting (Day/hour/minute)		day, AM/PM, 12/34	Fri/ PM/12/00	Sun~Sat/ AM~PM/0~12/0~60	Day, Hour, Minute

Main Menu	Sub Menu	Function		SEG No.	Default	Description	Unit
5	1	Daylight saving time application/ method	Daylight saving time application	1	0	0 - Disable, 1 - Enable	-
			Daylight saving time application method	2	0	0 - Weekly unit, 1 - Daily unit	-
	2	Beginning date of daylight saving time (Weekly unit) (?Month, ?th Sunday)	12,4	03,F	1~12 (Month) 1~4th,F(Final) week	-	
	3	Ending date of daylight saving time (Weekly unit) (?Month, ?th Sunday)	12,4	10,F	1~12 (Month) 1~4th,F(Final) week	-	
	4	Beginning date of daylight saving time (Daily unit) (Month, day)	12,34	0322	1~12 (Month), 1~31 (Day)	Month, day	
	5	Ending date of daylight saving time (Daily unit) (Month, day)	12,34	0922	1~12 (Month), 1~31 (Day)	Month, day	
6		Check/Set backlight duration		12	5	0~30 sec.	1 sec
8		Smart Tuning		12	0	-2 ~ +2	-
9		Displayed contents when power is OFF	Temperature, Time	1	0	0 - Off, 1 - Time only, 2 - Temperature only, 3 - Time and temperature	-
			Schedule	2	0	0 - Off, 1 - On	
0		Reset user mode to default value (except for current time)		1	0	0 - Disable, 1 - Reset	-



NOTE

- Refer to page 25 for detail instructions on how to change the settings from the user mode.

User mode

Information on the setting value

- 20 digits are available to be changed in the 'User Mode', they are presented in the form of two digits per page. Press the [>] button to move to the next page.

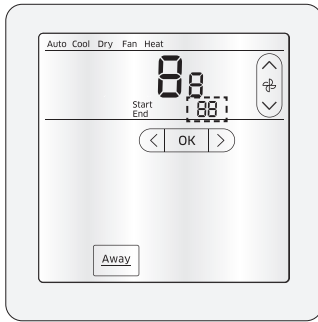

PAGE	DISPLAY	SEG	
1	Auto	SEG1	SEG2
2	Cool	SEG3	SEG4
3	Dry	SEG5	SEG6
4	Fan	SEG7	SEG8
5	Heat	SEG9	SEG10
6	Auto	SEG11	SEG12
7	Cool	SEG13	SEG14
8	Dry	SEG15	SEG16
9	Fan	SEG17	SEG18
10	Heat	SEG19	SEG20

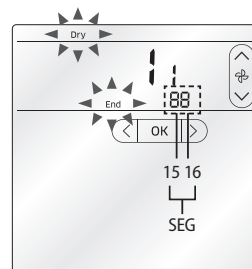
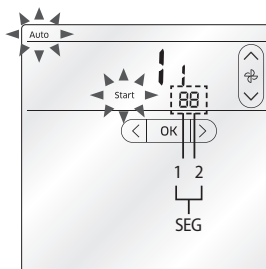

- As the 'Auto' mode and 'Start' indicators are displayed, it means you are setting the SEG1 and SEG2 in page 1.
- As the 'Dry' mode and 'End' indicators are displayed, it means you are setting the SEG15 and SEG16 in page 8.

How to change the settings from the user mode

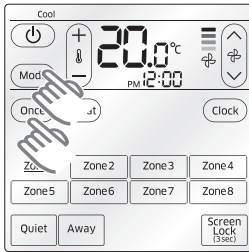

1. Tap and hold the **Mode** and **Once** button for 3 seconds.
 ▶ You will enter the user mode and number of main menu ("1") will be blinking.

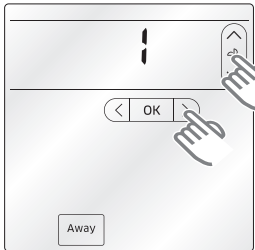

2. Select the Main menu.
 ▶ Tap \wedge , \vee button to select desired value.
 ▶ Tap > button to move to next page (item).

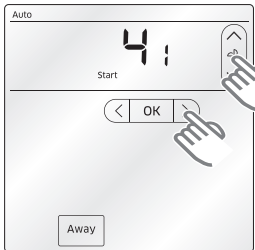

3. Select the sub men.
 ▶ This may not be available when there is no sub menu under main menu.
 ▶ Tap \wedge , \vee button to select desired value.
 ▶ Tap > button to move to next page (item).
 ▶ Tap < or **Away** button to move to previous page (item).

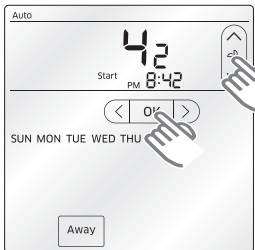

4. Change the setting.
 ▶ Tap \wedge , \vee button to select desired value.
 ▶ For some settings, you may have to select days (Sun~Sat) and time (AM/PM, hour, minute) by tapping \wedge , \vee button.
 ▶ Tap > button to move to next page (item).

5. Tap the **OK** button to complete the setting.
6. Tap the **Away** button to exit the user mode.



• When  icon blinks for 3 seconds after tapping the > button, it means there is no more page that you can move to.

MEMO

ENGLISH-26

MEMO

ENGLISH-27

